

**ARIZONA DIVISION OF EMERGENCY MANAGEMENT
REQUEST FOR PAYMENT FORM**

Proclamation #: 73051 Applicant Name: Pinal County

Project Worksheet #: PF-04 PW Name: Road network (Roadway Surfaces and Shoulders)

This PW was initially obligated for \$ \$109,457.91. We are requesting reimbursement in the amount of \$ _____. This project is _____% complete as of _____ (date).

Instructions for Applicant's Authorized Representative:

- In regards to the PW specified above, please enter the percentage of Work Completed, Date Complete and Amount Requested. Sign and Date where indicated below.
- **Please attach documentation to support your request.**
 - For reimbursement of Force Account Labor and Equipment, provide a brief summary of the total hours and estimated cost for labor and equipment.
 - For all other costs, provide the cover page for each invoice/receipt that shows: name of vendor, invoice/receipt number, date, and total amount.
 - Please do **NOT** include complete invoices or proof(s) of payment, which we require and will review later, upon project completion, at the Final Inspection/Audit.
- Complete and submit the "Supporting Documentation Expenditure Sheet" on the back, listing the costs being requested for reimbursement (by invoice).
- Please send your completed request to:

**Recovery - Infrastructure Coordinator
Arizona Division of Emergency Management
5636 E. McDowell Road, Bldg. M5101
Phoenix, Arizona 85008-3495**

I hereby certify that all costs claimed hereon are eligible in accordance with A.R.S. 35-192, as amended, all work claimed is complete as shown, and costs are supported by documentation available for review in our office.

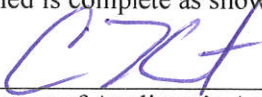
Signature of Applicant's Agent

Charles Kmet
Printed Name of Applicant's Agent

6/05/20
Date

520-251-2394
Applicant Agent's Phone Number

For ADEM Use Only		
Amount	Approved By:	Date

For ADEM Use Only	
RECEIVED BY: _____ (INITIALS & DATE)	Version 12-26-18

Supporting Documentation Expenditure Sheet

Vendor		Invoice #	Amount of Eligible Costs
1			
2			
3			
4			
5			
6			
7			
8			
9			
10			
11			
12			
13			
14			
15			
16			
17			
18			
19			
20			
21			
22			
23			
24			
25			
26			
27			
28			
29			
30			
31			
32			
33			
34			
35			
36			
37			
38			
39			
40			
TOTAL			



Douglas A. Ducey
GOVERNOR

STATE OF ARIZONA
DEPARTMENT OF EMERGENCY AND MILITARY AFFAIRS

5636 East McDowell Road
Phoenix, Arizona 85008-3495
(602) 267-2700 DSN: 853-2700



Major General Michael T. McGuire
THE ADJUTANT GENERAL

May 26, 2020

Charles Kmet
Emergency Manager
PO Box 727
31 North Pinal Street, Bldg F
Florence, AZ 85132

Re: Award Package #1
PCA 73051 – 2018 Pinal County Flooding
Pinal County

Mr. Kmet,

Enclosed is the Pinal County Award Package #1 for approved the Project Worksheet for PCA 73051 – 2018 Pinal County Flooding

PW	Project Title	State Reference No.	Approved Eligible Amount
PF-04	Roadway Surfaces & Shoulder	PF-04	\$109,457.91

This package includes the following items:

- 1) Two (2) copies of your Approved Project Worksheet(s) - **please sign and return one copy to our office.**
- 2) AZ PA 204-15 Request for Payment Form- after you have incurred costs (partial or in full), complete this form per the instructions and submit directly to my office for reimbursement. You can submit requests for reimbursements as you incur costs; you do not need to wait until the Project is completed.

Please review the enclosed package and contact me at (602) 464-6232 or Duke.Jones@azdema.gov with any concerns. If you do not have any questions at this time, please continue to move forward with project completion.

Sincerely,



Duke Jones
Infrastructure Coordinator

Enclosures

DO NOT DELETE THIS PAGE!

By filling out the yellow fields, the information will automatically populate the appropriate fields on each of the forms:

PW Date:	11/22/19
Disaster No:	73051
Disaster Type	DR
State Abbreviation:	AZ
County:	Pinal County
Applicant Name:	Pinal County
Category:	C
FIPS No:	
PW Reference Number:	PF-04
Location	Maricopa, AZ
Damaged Facility	Road Network (Roadway Surfaces & Shoulders)
Year Facility Constructed:	
PW Prepared By:	Alex Barber
Preparer Title:	ADEM Project Specialist
DEMA PDMG	Alex Barber
DEMA QAQC Reviewer:	Dennis Erickson
Kick Off Meeting Date:	11/27/18
Applicant Representative:	Michael Campbell
Applicant Representative Title:	Road Maintenance Supervisor
Applicant Representative Phone No:	(520) 705-0963
State Contact Info (Name & Title):	Thomas "Duke" Jones - Infrastructure Coord.
State Contact Info (Facility):	ADEM Recovery Office
State Contact Info (Address):	5636 E. McDowell Rd, Phoenix, AZ 85008
State Contact Info (Phone Numbers):	(602)464-6504

**Sign
Your signed Copy.
Keep for your Files.**

Arizona Department for Emergency & Military Affairs
ARIZONA DIVISION OF EMERGENCY MANAGEMENT

PROJECT WORKSHEET

DECLARATION NO.	PW REF NO.	DATE	FIPS NO.	CATEGORY	EMMIE NO.
ADEM 73051 DR AZ	PF-04	11/22/19	0	C	
APPLICANT				WORK COMPLETED AS OF:	
Pinal County				DATE:	PERCENT:
				11/28/18	5%
DAMAGED FACILITY				COUNTY	
Road Network (Roadway Surfaces & Shoulders)				Pinal County	
LOCATION				LATITUDE	LONGITUDE
Maricopa, AZ				32.87998	-112.04037

Was this site previously damaged? ☐ Yes ☒ No ☐ Unsure

DAMAGE DESCRIPTION AND DIMENSIONS:

On 1 thru 4 Oct 2018, the remnants of Pacific Hurricane Rosa produced extensive thunderstorms across central and southwestern Arizona, resulting in heavy rainfall and causing flash flooding in low lying areas. This flash flooding caused significant erosion damage to roadway surfaces, shoulders, and culverts at 22 sites in the western portion of Pinal County.

Site 1: Huisatch Rd & Amarillo Valley Rd Intersection (32.88758, -112.08335)

Erosion damage occurred to the road surface at the intersection of Huisatch road and Amarillo Valley road. The erosion led caused a loss of double chip seal road surface over an area with a dimension of 190 ft L x 28ft W (approximately 5,320 sq ft).

(DDD continued on Scope Continuation Tab)

SCOPE OF WORK:

WORK TO BE COMPLETED

Site 1:

Pinal County Public Works Department will restore the roadway to pre-disaster condition by removing the damaged chip seal and roadway base, backfilling, compacting, and installing new double chip seal (190 ft L x 28 ft W = 5,320 sq ft / 9 = 591 sq yds) using force account labor and equipment.

(SOW continued on Scope Continuation Tab)

Does the Scope of Work change the pre-disaster conditions at the site?

☐ Yes ☒ No

Special Considerations issues included?

☒ Yes ☐ No

Is there insurance coverage on this facility?

☐ Yes ☒ No

Hazard Mitigation proposal included?

☐ Yes ☒ No

PROJECT COST

ITEM	CODE	NARRATIVE	QUANTITY	UNIT	UNIT PRICE	COST
WORK TO BE COMPLETED						
1	9007	Labor - Force Account	1	LS	\$ 24,382.50	\$ 24,382.50
2	9008	Equipment - Force Account	1	LS	\$ 42,417.14	\$ 42,417.14
3	9009	Material	1	LS	\$ 42,658.27	\$ 42,658.27
4	9999	Other - Rental	0	LS	\$ -	\$ -

SUBTOTAL FROM COST CONTINUATION PAGE(S)

TOTAL PROJECT COST \$ 109,457.91

PREPARED BY: Alex Barber

TITLE: ADEM Project Specialist

PDMG Alex Barber

APPLICANT: Michael Campbell

DATE: 6/8/2020

PHONE: (520) 705-0963

ARIZONA DIVISION OF EMERGENCY MANAGEMENT

DAMAGE DESCRIPTION & SCOPE OF WORK

DECLARATION NO.				PW REF NO.	DATE	FIPS NO.	CATEGORY	NEMIS NO.
ADEM	73051	DR	AZ	PF-04	11/22/19		C	
APPLICANT							COUNTY	
Pinal County							Pinal County	

DAMAGE DESCRIPTION & SCOPE OF WORK (CONTINUED):

Page 2 of 8

WORK TO BE COMPLETED

(Site 1 SOW Continued)

Site 1 Totals:

Labor: = \$900.00

Equipment: = \$1,435.00

Materials (Double Chip Seal): = \$4,320.21

Other: = \$0.00

Total Cost: \$6,655.21

DAMAGE DESCRIPTION**Site 2: Amarillo Valley Rd & Meadow Green Rd Intersection (32.89347, -112.08346)**

Erosion damage occurred to the intersection of Amarillo Valley road and Meadow Green road. The erosion led to the loss of double chip seal road surface material over an area with a dimension of 180 ft L x 28 ft W (approximately 5,040 sq ft).

SCOPE OF WORK**Site 2:**

Pinal County Public Works Department will restore the roadway to pre-disaster condition by removing the damaged chip seal and roadway base, backfilling, compacting and installing new double chip seal (180 ft L x 28 ft W = 5,040 sq ft / 9 = 560 sq yds) using force account labor and equipment.

Site 2 Totals:

Labor: = \$900.00

Equipment: = \$1,435.00

Materials (Double Chip Seal): = \$4,093.60

Other: = \$0.00

Total Cost: = \$6,428.60

See LEMO Tabs for breakdown of costs.

DAMAGE DESCRIPTION**Site 3: Barnes Rd & Amarillo Valley Rd Intersection (32.92750, -112.08354)**

Erosion damage occurred to the road surface at the intersection of Barnes road and Amarillo Valley road causing a loss of the double chip seal road surface across an area with a dimension of 65 ft L x 28 ft W (approximately 1,820 sq ft).

Erosion damage occurred to the shoulder at the intersection of Barnes road and Amarillo Valley road causing a loss of select material across the distance of 65 ft L x 5 ft W x 2 ft D (approximately 650 cu ft).

(SOW Continued on Scope Continuation Tab 2)

PREPARED BY: Alex Barber

TITLE: ADEM Project Specialist

ARIZONA DIVISION OF EMERGENCY MANAGEMENT

DAMAGE DESCRIPTION & SCOPE OF WORK

DECLARATION NO.				PW REF NO.	DATE	FIPS NO.	CATEGORY	NEMIS NO.
ADEM	73051	DR	AZ	PF-04	11/22/19		C	
APPLICANT							COUNTY	
Pinal County							Pinal County	

DAMAGE DESCRIPTION & SCOPE OF WORK (CONTINUED):

Page 4 of 8

WORK TO BE COMPLETED - Continued
SCOPE OF WORK

Site 3:

Pinal County Public Works Department will restore the roadway and shoulder intersection to pre-disaster condition by removing the damaged chip seal and roadway base, backfilling, compacting and installing new double chip seal (65 ft L x 28 ft W = 1,820 sq ft / 9 = 202 sq yds) and select material (65 ft L x 5 ft W x 2 ft D = 650 CF/27 = 24 cu yds x 1.5 = 36 tons) using force account labor and equipment.

Site 3 Totals:**Labor:** = \$1,275.00**Equipment:** = \$2,169.22**Materials:** = \$1,564.60**Other:** = \$0.00**Total Cost:** \$5,008.82**DAMAGE DESCRIPTION****Site 4: Amarillo Valley Rd (between Louis Johnson Rd & Teel Rd) (32.94004, -112.08308)**

Erosion damage occurred to Amarillo Valley road between Louis Johnson road and Teel road causing a loss of the double chip seal road surface for a distance of 150 ft L x 28 ft W (approximately 4,200 sq ft).

Erosion damage occurred to the shoulder along Amarillo Valley road between Louis Johnson road and Teel road over a distance of 350 ft L x 4 ft W x 1 ft D (approximately 1,400 cu ft).

SCOPE OF WORK**Site 4:**

Pinal County Public Works Department will restore the roadway and shoulder to pre-disaster condition by removing the damaged chip seal and roadway base, backfilling, compacting and installing new double chip seal (150-ft L x 28-ft W = 4,200 sq ft / 9 = 467 sq yds) and select material (350-ft L x 4-ft W x 1-ft D = 1,400 CF/ 27 = 52 cu yds x 1.5 = 78 tons) along the shoulder using force account labor and equipment.

Site 4 Totals:**Labor:** = \$1,500.00**Equipment:** = \$2,847.80**Materials:** = \$3,608.77**Other:** = \$0.00**Total Cost:** \$7,956.57**DAMAGE DESCRIPTION****Site 5: Barnes Rd & Appaloosa Dip (32.92753, -112.11058)**

Erosion damage occurred to the intersection of Barnes road and Appaloosa Dip causing a loss of the double chip seal road surface over an area with a dimension of 300 ft L x 28 ft W (approximately 8,400 sq ft).

Erosion damage occurred to the shoulder at the intersection of Barnes road and Appaloosa Dip causing a loss of select material in an area with the dimensions of 75 ft L x 10 ft W x 3 ft D (approximately 2,250 cu ft).

(SOW Continued on Scope Continuation Tab 3)

PREPARED BY: Alex Barber

TITLE: ADEM Project Specialist

ARIZONA DIVISION OF EMERGENCY MANAGEMENT

DAMAGE DESCRIPTION & SCOPE OF WORK

DECLARATION NO.				PW REF NO.	DATE	FIPS NO.	CATEGORY	NEMIS NO.
ADEM	73051	DR	AZ	PF-04	11/22/19		C	
APPLICANT							COUNTY	
Pinal County							Pinal County	

DAMAGE DESCRIPTION & SCOPE OF WORK (CONTINUED):

Page 5 of 8

WORK TO BE COMPLETED - Continued
SCOPE OF WORK

Site 5:

Pinal County Public Works Department will restore the roadway and shoulder to pre-disaster condition by removing the damaged chip seal and roadway base, backfilling, compacting and installing new double chip seal (300-ft L x 28-ft W = 8,400 sq ft / 9 = 934 sq yds) on the road surface and select material (75-ft L x 10-ft W x 3-ft D = 2,250 CF / 27 = 84 cu yds x 1.5 = 125 tons) on the shoulder using force account labor and equipment.

Site 5 Totals:

Labor: = \$1,440.00

Equipment: = 2,494.66

Materials: = \$7,140.04

Other: = \$0.00

Total Cost: = \$11,164.24

DAMAGE DESCRIPTION**Site 6: Liebre Rd at State Route 84 (32.86003, -11207530)**

Erosion damage occurred to Liebre road at State Route 84, unpaved road surface causing a loss of select material across an area with a dimension of 146 ft L x 28 ft W x 2 ft D (approximately 8,176 cu ft).

(Note: Pinal County intends to add new chip seal to this site if possible. The roadway was unpaved at time of disaster and DEMA will consider this work at the time of final inspection).

SCOPE OF WORK**Site 6:**

Pinal County Public Works Department repaired the roadway to pre-disaster condition by backfilling, grading, and compacting select material (146 ft L x 28 ft W x 2 ft D = 8,176 cu ft / 27 = 303 cu yds x 1.5 = 455 tons) using force account labor and equipment.

Site 6 Totals:

Labor: = \$2,130.00

Equipment: = \$3,896.88

Materials: = \$1,137.50

Other: = \$0.00

Total Cost: \$7,164.38

DAMAGE DESCRIPTION**Site 7: Wildwood Rd (between Garnett Rd & Pick Rd) (32.88036, -112.09890)**

Erosion damage occurred to Wildwood road between Garnett road and Pick road causing a loss of the double chip seal road surface across an area with a dimension of 200 ft L x 28 ft W (approximately 5,600 sq ft).

(SOW Continued on Scope Continuation Tab 4)

PREPARED BY: Alex Barber

TITLE: ADEM Project Specialist

ARIZONA DIVISION OF EMERGENCY MANAGEMENT

DAMAGE DESCRIPTION & SCOPE OF WORK

DECLARATION NO.				PW REF NO.	DATE	FIPS NO.	CATEGORY	NEMIS NO.
ADEM	73051	DR	AZ	PF-04	11/22/19		C	
APPLICANT							COUNTY	
Pinal County							Pinal County	

DAMAGE DESCRIPTION & SCOPE OF WORK (CONTINUED):

Page 6 of 8

WORK TO BE COMPLETED - Continued**SCOPE OF WORK****Site 7**

Pinal County Public Works Dept will restore the roadway to pre-disaster condition by removing the damaged chip seal and roadway base, backfilling, compaction and installation of new double chip seal (200-ft L x 28-ft W = 5,600 sq ft / 9 = 622 sq yds) using force account labor and equipment.

Site 7 Totals

Labor: = \$900.00

Equipment: = \$1,435.00

Materials = \$4,546.82

Other: \$0.00

Total Cost: \$6,881.82

DAMAGE DESCRIPTION**Site 8: Fulcar Rd (32.99275, -112.17243)**

Erosion damage occurred to the road surface of Fulcar road causing a loss of the double chip seal road surface over an area with a dimension of 200-ft L x 22-ft W (approximately 4,400 sq ft).

Erosion damage occurred to the south side shoulder of Fulcar causing the loss of select material along an area with a dimension of 590-ft L x 4-ft W x 1-ft D (approximately 2,360 cu ft).

SCOPE OF WORK**Site 8:**

Pinal County Public Works Department will restore the roadway and shoulder to pre-disaster condition by removing the damaged chip seal and roadway base, backfilling, compacting and installing new double chip seal (200-ft L x 22-ft W = 4,400 sq ft / 9 = 489 sq yds) and select material (590-ft L x 4-ft W x 1-ft D = 2,360 CF / 27 = 88 cu yds x 1.5 = 132 tons) using force account labor and equipment.

Site 8 Totals:

Labor: = \$1,455.00

Equipment: = \$2,249.50

Materials: = \$3,904.59

Other: \$0.00

Total Cost: \$7,609.09

(SOW Continued on Scope Continuation Tab 5)

PREPARED BY: Alex Barber

TITLE: ADEM Project Specialist

ARIZONA DIVISION OF EMERGENCY MANAGEMENT

DAMAGE DESCRIPTION & SCOPE OF WORK

DECLARATION NO.				PW REF NO.	DATE	FIPS NO.	CATEGORY	NEMIS NO.
ADEM	73051	DR	AZ	PF-04	11/22/19		C	
APPLICANT							COUNTY	
Pinal County							Pinal County	

DAMAGE DESCRIPTION & SCOPE OF WORK (CONTINUED):

Page 6 of 8

WORK TO BE COMPLETED - Continued
DAMAGE DESCRIPTION

Site 9: Warren Rd (between Farrell Rd & McDavid Rd) (33.05081, -112.13456)

Erosion damage occurred to Warren road (between Farrell road and McDavid road) causing a loss of the double chip seal road surface with a over a dimension of 120-ft L x 28-ft W (approximately 3,360 sq ft).

Erosion damage occurred to shoulder with a dimension of 420-ft L x 6-ft W x 1-ft D.

SCOPE OF WORK**Site 9:**

Pinal County Public Works Dept will restore the roadway and shoulder to pre-disaster condition by removing the damaged chip seal and roadway base, backfilling, compaction and installation of new double chip seal (120-ft L x 28-ft W = 3,360 sq ft / 9 = 373 sq yds) and select material (420-ft L x 6-ft W x 1-ft D = 2,520 CF / 27 = 93 cu yds x 1.5 = 140 tons) using force account labor and equipment.

Site 9 Totals:**Labor:** = \$1,762.50**Equipment:** = \$2,853.02**Materials:** = \$3,076.63**Other:** \$0.000**Total Cost:** \$7,692.15**DAMAGE DESCRIPTION****Site 10: McDavid Rd (West of Warren Rd) (33.05777, -112.14295)**

Erosion damage occurred on McDavid road west of Warrant Road. The erosion led to the loss of double chip seal from the road surface across and area with the dimension of 36-ft L x 28-ft W (approximately 1,008 sq ft).

SCOPE OF WORK**Site 10:**

Pinal County Public Works Department will restore the roadway to pre-disaster condition by removing the damaged chip seal and roadway base, backfilling, compacting and installing double chip seal (36-ft L x 28-ft W = 1,008 sq ft / 9 = 112 sq yds) using force account labor and equipment.

Site 10 Totals:**Labor:** = \$900.00**Equipment:** = \$1,435.00**Materials** = \$818.72**Other:** \$0.00**Total Cost:** \$3,153.72

(SOW Continued on Scope Continuation Tab 6)

PREPARED BY: Alex Barber

TITLE: ADEM Project Specialist

ARIZONA DIVISION OF EMERGENCY MANAGEMENT

DAMAGE DESCRIPTION & SCOPE OF WORK

DECLARATION NO.				PW REF NO.	DATE	FIPS NO.	CATEGORY	NEMIS NO.
ADEM	73051	DR	AZ	PF-04	11/22/19		C	
APPLICANT							COUNTY	
Pinal County							Pinal County	

DAMAGE DESCRIPTION & SCOPE OF WORK (CONTINUED):

Page 6 of 8

WORK TO BE COMPLETED - Continued
DAMAGE DESCRIPTION

Site 11: McDavid Rd (33.05774, -112.14474)

Erosion damage occurred to the road surface of McDavid road causing a loss of double chip seal over an area with the dimension of 140-ft L x 28-ft W (approximately 3,920 sq ft).

SCOPE OF WORK**Site 11:**

Pinal County Public Works Dept will restore the roadway to pre-disaster condition by removing the damaged chip seal and roadway base, backfilling, compacting and installing double chip seal (140-ft L x 28-ft W = 3,920 sq ft / 9 = 436 sq yds) using force account labor and equipment.

Site 11: Totals

Labor: = \$900.00

Equipment: = \$1,435.00

Materials = \$3,187.16

Other = \$0.00

Total Cost: \$5,522.16

DAMAGE DESCRIPTION**Site 12: Teel Rd & Green Rd Intersection (32.95433, -112.06566)**

Erosion damage occurred to the unpaved intersection of Teel road and Green road causing the loss of select material over a dimension of 444-ft L x 26-ft W x 1-ft D (approximately 11,544 cu ft).

Erosion damage occurred to the unpaved shoulders at the intersection of Teel Rd and Green road causing a loss of select material along an area with the dimensions of 1,190-ft L x 26-ft W x 1-ft D (approximately 30,940).

SCOPE OF WORK**Site 12:**

Pinal County Public Works Dept will restore the intersection roadway and shoulder to pre-disaster condition by removing the damaged chip seal and roadway base, backfilling, compacting and installing of select material (Select Material Road Surface: 444-ft L x 26-ft W x 1-ft D = 11,544 cu ft / 27 = 427 cu yds x 1.5 = 641.33 tons and Select Material Shoulder: 1,190-ft L x 26-ft W x 1-ft D = 30,940 CF / 27 = 1,146 cu yds x 1.5 = 1,719 tons) using force account labor and equipment.

Site 12 Totals:

Labor: = \$10,320.00

Equipment: = \$19,104.40

Materials = \$5,900.83

Other: = \$0.00

Total Cost: \$33,722.40

(SOW Continued on Scope Continuation Tab 7)

PREPARED BY: Alex Barber

TITLE: ADEM Project Specialist

ARIZONA DIVISION OF EMERGENCY MANAGEMENT

DAMAGE DESCRIPTION & SCOPE OF WORK

DECLARATION NO.				PW REF NO.	DATE	FIPS NO.	CATEGORY	NEMIS NO.
ADEM	73051	DR	AZ	PF-04	11/22/19		C	
APPLICANT							COUNTY	
Pinal County							Pinal County	

DAMAGE DESCRIPTION & SCOPE OF WORK (CONTINUED):

Page 7 of 8

SUMMARY**WORK TO BE COMPLETED****Total Estimated Costs for this PW**

Estimated Labor Cost Total:	\$ 24,382.50
Estimated Equipment Cost Total:	\$ 42,417.14
Estimated Materials Cost Total:	\$ 42,658.27
Estimated Other Cost Total:	\$ 0.00

Estimated Total Cost of this PW: \$109,457.91

Labor Costs (Force Account): The ADEM Project Specialist has discussed labor records with the applicant and advised that labor rates for this type of work be eligible under the ADEM Public Assistance Program. Labor records are on file and available at the applicant's office.

Equipment Costs (Force Account): The ADEM Project Specialist has discussed equipment cost records with the applicant and has verified that the rates for individual pieces of equipment are reasonable and eligible under the ADEM Public Assistance Program. This applicant was requested to use equipment rates that are equal to or less than the FEMA equipment rate. Equipment-cost records are on file at the applicant's office.

Material Costs: The ADEM Project Specialist has discussed material cost records with the applicant and has advised that the unit cost for each material type is reasonable and eligible under the ADEM Public Assistance Program. Material-cost records are on file at the applicant's office.

Documentation Requirement: Applicant is to maintain financial and program records for three (3) years from the completion of the applicant's final audit and shall be available for inspection and audit at all reasonable times by the Department and the Auditor General.

Work Footprint: All work will be done in its original footprint.

Work Permits: Applicant is responsible for obtaining all necessary local, State and/or Federal permits.

Right-of-Way: Applicant must demonstrate that they had the responsibility and the right-of-way to maintain the facility, structure, or roadway at the time of the disaster.

(SOW Continued on Scope Continuation Tab 8)

PREPARED BY: Alex Barber

TITLE: ADEM Project Specialist

ARIZONA DIVISION OF EMERGENCY MANAGEMENT

DAMAGE DESCRIPTION & SCOPE OF WORK

DECLARATION NO.				PW REF NO.	DATE	FIPS NO.	CATEGORY	NEMIS NO.
ADEM	73051	DR	AZ	PF-04	11/22/19		C	
APPLICANT							COUNTY	
Pinal County							Pinal County	

DAMAGE DESCRIPTION & SCOPE OF WORK (CONTINUED):

Page 8 of 8

Federal Highways: The ADEM Project Specialist has verified with ADOT, ERFO, or FHWA classification maps that this/these road(s) are not part of the Federal Aid Road System.

Title 8, Chapter 2, Article 3: Applicant must comply with the Title 8 Arizona Administrative Code as revised on December 1, 2013.

Disaster Assistance Agreement: Applicant must comply with the signed Disaster Assistance Agreement.

ADEM Generated Cost Estimates: Adequate cost documentation supporting this project worksheet was not provided by the Applicant. Therefore, the cost estimates used were prepared by ADEM and are based on reasonable and accepted practices. If additional cost documentation is provided by the Applicant, a version for this worksheet may be prepared.

PREPARED BY: Alex Barber

TITLE: ADEM Project Specialist

SCOPE NOTES

APPLICANT	PW REF NO.	CATEGORY	FIPS NO.	DISASTER	
Pinal County	PF-04	C		AZ	73051

Check next to appropriate comment for Data Specialist to add to the Scope of Work

Topic	Comment
Record Retention	Complete records and cost documents for all approved work must be maintained for at least 3 years from the date the disaster grant was closed.
Mitigation	No Mitigation Opportunities Identified because: <input type="checkbox"/> PW is for Emergency Work - Mitigation not eligible. <input type="checkbox"/> Work already completed and no add-on mitigation is feasible. <input type="checkbox"/> Mitigation not technically feasible. <input checked="" type="checkbox"/> Applicant has refused mitigation.
CEF	<input type="checkbox"/> This large project was estimated using the Cost Estimated Format (CEF)
CEF - Not Used	This large project was not estimated using the CEF because: <input type="checkbox"/> The PW is for Emergency Work. <input type="checkbox"/> The work is greater than 90% complete at the time of inspection.
	<input type="checkbox"/>
	<input type="checkbox"/>
	<input type="checkbox"/>
	<input type="checkbox"/>

PREPARED BY: Alex Barber

TITLE: ADEM Project Specialist

SPECIAL CONSIDERATIONS

DISASTER	APPLICANT NAME	PW REF NO.	FIPS NO.	DATE
73051 AZ	Pinal County	PF-04		11/22/19

1. Does the damaged facility or item of work have insurance and/or is it an insurable risk? (e.g., buildings, equipment, vehicles, etc.)

☐ Yes ☒ No ☐ Unsure

If anything is marked yes, you must include a narrative as to why.

2. Is the damaged facility located within a floodplain or coastal high hazard area, or does it have an impact on a floodplain or wetland?

☐ Yes ☒ No ☐ Unsure

FIRMette panel 04021C1100E is attached. None of the damage sites are located in any flood zones.

3. Is the damaged facility or item of work located within or adjacent to a Coastal Barrier Resource System Unit or an Otherwise Protected Area?

☐ Yes ☒ No ☐ Unsure

4. Will the proposed facility repairs/reconstruction change the pre-disaster condition? (e.g., footprint, material, location, capacity, use or function)

☐ Yes ☒ No ☐ Unsure

5. Does the applicant have a hazard mitigation proposal or would the applicant like technical assistance for a hazard proposal?

☐ Yes ☒ No ☐ Unsure

6. Is the damaged facility on the National Register of Historic Places or the state historic listing? Is it older than 50 years? Are there more, similar buildings near the site?

☐ Yes ☒ No ☐ Unsure

Facility Constructed In: 2014

7. Are there any pristine or undisturbed areas on, or near, the project site? Are there large tracts of forestland?

☐ Yes ☒ No ☐ Unsure

8. Are there any hazardous materials at or adjacent to the damaged facility and/or item of work?

☐ Yes ☒ No ☐ Unsure

9. Are there any other environmentally or controversial issues associated with the damaged facility and/or item of work?

☐ Yes ☒ No ☐ Unsure

Site 2 location is part of a nature preserve.

PREPARED BY: Alex Barber

Applicant:	Pinal County
Disaster:	PCA 73051
PW #:	PF-04
Category:	C

Labor (FA) Reg Hours	812.75
Labor (FA) OT Hours	0.00
Equipment (FA) Hours	812.50
Labor Cost (FA) Reg	\$ 24,382.50
Labor Cost (FA) OT	\$ -
Labor Cost; Total	\$ 24,382.50
Equipment (FA)	\$ 42,417.14
Materials (County)	\$ 42,658.27
Other Costs	\$ -
Grand Totals	\$ 109,457.91

DAC Total \$0.00

I certify that the information included within this LEMO workbook, was obtained from payroll records, vehicle logs, invoices/receipts, or other documents that are available for audit. _____ init.

I further certify that the information included within this LEMO is an estimation of the costs incurred as a direct result of work performed specifically for this declared disaster. _____ init.

(FOR FEDERAL DECLARATIONS ONLY)

SELECT ONE ONLY

We are requesting Direct Admin Costs for this PW _____ init.

We are NOT requesting DAC for this PW _____ init.

Signature: _____

Printed Name: _____

Title: _____

Date: _____

Comments / Notes:

Reviewed and awaiting input from applicant 01MAR2019 AB2. The PW was updated with date, data, and reviewed with PF-04 word document and PW PF-04 draft on 26JUL19 by AB2. Final version sent to Duke for review and obligation on 30 JUL 2019, AB2

Do NOT add or delete columns or rows to any portion of this workbook!

1		B		C		D		E		F		G		H		I		J		K		L		M		N		O		P		Q		R					
2		APPLICANT		Pinel County		DISASTER		PCA 3051		CAT		C		PW#		PT-04		Updated		EQUIPMENT										COMMENTS									
3		Site Name or Number		Employee Name		REG RATE (with ERE)		OT RATE (with ERE)		REG HOURS		OT HOURS		REG COST (with ERE)		OT COST (with ERE)		TOTAL LABOR (with ERE)		EQUIP TYPE		EQUIP ID #		FEMA CODE		RATE		HRS (or Mileage)		TOTAL		Comments							
4		Date		10/23/16		\$ 30.00		\$ 30.00		8.00		2.00		\$ 240.00		\$ 60.00		\$ 300.00		Truck (8791) @ \$46.00/hr + Dump Trailer (\$591) @ \$11.36/hr = \$57.36/hr		50032		8023		\$ 35.76		10.00		\$ 357.60		Truck (8791) @ \$46.00/hr + Dump Trailer (\$591) @ \$11.36/hr = \$57.36/hr							
5		10/23/16		Operator 1		\$ 30.00		\$ 30.00		10.00		-		\$ 300.00		\$ -		\$ 300.00		Grader		8332		8781		\$ 50.00		10.00		\$ 675.00									
6		10/23/16		Operator 2		\$ 30.00		\$ 30.00		10.00		-		\$ 300.00		\$ -		\$ 300.00		4K Water Truck		8781		8781		\$ 50.00		10.00		\$ 500.00									
7		10/23/16		Operator 3		\$ 30.00		\$ 30.00		10.00		-		\$ 300.00		\$ -		\$ 300.00		Compactor Vibratory Drum		8221		8221		\$ 31.70		10.00		\$ 317.00									
8		10/23/16		Operator 4		\$ 30.00		\$ 30.00		8.00		-		\$ 240.00		\$ -		\$ 240.00		Wheel Loader		8395		8395		\$ 64.00		8.00		\$ 512.00									
9		10/23/16		Operator 5		\$ 30.00		\$ 30.00		33.00		-		\$ 990.00		\$ -		\$ 990.00		COMBO - Truck Tractor & Dump Trailer		8395		8395		\$ 57.36		33.00		\$ 1,892.88		Truck (8791) @ \$46.00/hr + Dump Trailer (\$591) @ \$11.36/hr = \$57.36/hr							
10		10/23/16		Operator 1		\$ 30.00		\$ 30.00		10.00		-		\$ 300.00		\$ -		\$ 300.00		Grader		8332		8332		\$ 67.50		10.00		\$ 675.00									
11		10/23/16		Operator 2		\$ 30.00		\$ 30.00		10.00		-		\$ 300.00		\$ -		\$ 300.00		4K Water Truck		8781		8781		\$ 50.00		10.00		\$ 500.00									
12		10/23/16		Operator 3		\$ 30.00		\$ 30.00		10.00		-		\$ 300.00		\$ -		\$ 300.00		Compactor Pneumatic Wheel		8223		8223		\$ 26.00		10.00		\$ 260.00									
13		10/23/16		Operator 1		\$ 30.00		\$ 30.00		10.00		-		\$ 300.00		\$ -		\$ 300.00		COMBO - Truck Tractor & Dump Trailer		8395		8395		\$ 57.36		2.00		\$ 114.72		Truck (8791) @ \$46.00/hr + Dump Trailer (\$591) @ \$11.36/hr = \$57.36/hr							
14		10/23/16		Operator 2		\$ 30.00		\$ 30.00		10.00		-		\$ 300.00		\$ -		\$ 300.00		Grader		8332		8332		\$ 67.50		10.00		\$ 675.00									
15		10/23/16		Operator 3		\$ 30.00		\$ 30.00		10.00		-		\$ 300.00		\$ -		\$ 300.00		Compactor Pneumatic Wheel		8223		8223		\$ 26.00		10.00		\$ 260.00									
16		10/23/16		Operator 1		\$ 30.00		\$ 30.00		10.00		-		\$ 300.00		\$ -		\$ 300.00		Grader		8332		8332		\$ 67.50		10.00		\$ 675.00									
17		10/23/16		Operator 2		\$ 30.00		\$ 30.00		10.00		-		\$ 300.00		\$ -		\$ 300.00		4K Water Truck		8781		8781		\$ 50.00		10.00		\$ 500.00									
18		10/23/16		Operator 3		\$ 30.00		\$ 30.00		10.00		-		\$ 300.00		\$ -		\$ 300.00		Compactor Pneumatic Wheel		8223		8223		\$ 26.00		10.00		\$ 260.00									
19		10/23/16		Operator 1		\$ 30.00		\$ 30.00		10.00		-		\$ 300.00		\$ -		\$ 300.00		Grader		8332		8332		\$ 67.50		10.00		\$ 675.00									
20		10/23/16		Operator 2		\$ 30.00		\$ 30.00		10.00		-		\$ 300.00		\$ -		\$ 300.00		4K Water Truck		8781		8781		\$ 50.00		10.00		\$ 500.00									
21		10/23/16		Operator 3		\$ 30.00		\$ 30.00		10.00		-		\$ 300.00		\$ -		\$ 300.00		Compactor Pneumatic Wheel		8223		8223		\$ 26.00		10.00		\$ 260.00									
22		10/23/16		Operator 1		\$ 30.00		\$ 30.00		10.00		-		\$ 300.00		\$ -		\$ 300.00		Grader		8332		8332		\$ 67.50		10.00		\$ 675.00									
23		10/23/16		Operator 2		\$ 30.00		\$ 30.00		10.00		-		\$ 300.00		\$ -		\$ 300.00		4K Water Truck		8781		8781		\$ 50.00		10.00		\$ 500.00									
24		10/23/16		Operator 3		\$ 30.00		\$ 30.00		10.00		-		\$ 300.00		\$ -		\$ 300.00		Compactor Pneumatic Wheel		8223		8223		\$ 26.00		10.00		\$ 260.00									
25		10/23/16		Operator 1		\$ 30.00		\$ 30.00		10.00		-		\$ 300.00		\$ -		\$ 300.00		Grader		8332		8332		\$ 67.50		10.00		\$ 675.00									
26		10/23/16		Operator 2		\$ 30.00		\$ 30.00		10.00		-		\$ 300.00		\$ -		\$ 300.00		4K Water Truck		8781		8781		\$ 50.00		10.00		\$ 500.00									
27		10/23/16		Operator 3		\$ 30.00		\$ 30.00		10.00		-		\$ 300.00		\$ -		\$ 300.00		Compactor Pneumatic Wheel		8223		8223		\$ 26.00		10.00		\$ 260.00									
28		10/23/16		Operator 1		\$ 30.00		\$ 30.00		10.00		-		\$ 300.00		\$ -		\$ 300.00		Grader		8332		8332		\$ 67.50		10.00		\$ 675.00									
29		10/23/16		Operator 2		\$ 30.00		\$ 30.00		10.00		-		\$ 300.00		\$ -		\$ 300.00		4K Water Truck		8781		8781		\$ 50.00		10.00		\$ 500.00									
30		10/23/16		Operator 3		\$ 30.00		\$ 30.00		10.00		-		\$ 300.00		\$ -		\$ 300.00		Compactor Pneumatic Wheel		8223		8223		\$ 26.00		10.00		\$ 260.00									
31		10/23/16		Operator 1		\$ 30.00		\$ 30.00		10.00		-		\$ 300.00		\$ -		\$ 300.00		Grader		8332		8332		\$ 67.50		10.00		\$ 675.00									
32		10/23/16		Operator 2		\$ 30.00		\$ 30.00		10.00		-		\$ 300.00		\$ -		\$ 300.00		4K Water Truck		8781		8781		\$ 50.00		10.00		\$ 500.00									
33		10/23/16		Operator 3		\$ 30.00		\$ 30.00		10.00		-		\$ 300.00		\$ -		\$ 300.00		Compactor Pneumatic Wheel		8223		8223		\$ 26.00		10.00		\$ 260.00									
34		10/23/16		Operator 1		\$ 30.00		\$ 30.00		10.00		-		\$ 300.00		\$ -		\$ 300.00		Grader		8332		8332		\$ 67.50		10.00		\$ 675.00									
35		10/23/16		Operator 2		\$ 30.00		\$ 30.00		10.00		-		\$ 300.00		\$ -		\$ 300.00		4K Water Truck		8781		8781		\$ 50.00		10.00		\$ 500.00									
36		10/23/16		Operator 3		\$ 30.00		\$ 30.00		10.00		-		\$ 300.00		\$ -		\$ 300.00		Compactor Pneumatic Wheel		8223		8223		\$ 26.00		10.00		\$ 260.00									
37		10/23/16		Operator 1		\$ 30.00		\$ 30.00		10.00		-		\$ 300.00		\$ -		\$ 300.00		Grader		8332		8332		\$ 67.50		10.00		\$ 675.00									
38		10/23/16		Operator 2		\$ 30.00		\$ 30.00		10.00		-		\$ 300.00		\$ -		\$ 300.00		4K Water Truck		8781		8781		\$ 50.00		10.00		\$ 500.00									
39		10/23/16		Operator 3		\$ 30.00		\$ 30.00		10.00		-		\$ 300.00		\$ -		\$ 300.00		Compactor Pneumatic Wheel		8223		8223		\$ 26.00		10.00		\$ 260.00									
40		10/23/16		Operator 1		\$ 30.00		\$ 30.00		10.00		-		\$ 300.00		\$ -		\$ 300.00		Grader		8332		8332		\$ 67.50		10.00		\$ 675.00									
41		10/23/16		Operator 2		\$ 30.00		\$ 30.00		10.00		-		\$ 300.00		\$ -		\$ 300.00		4K Water Truck		8781		8781		\$ 50.00		10.00		\$ 500.00									
42		10/23/16		Operator 3		\$ 30.00		\$ 30.00		10.00		-		\$ 300.00		\$ -		\$ 300.00		Compactor Pneumatic Wheel		8223		8223		\$ 26.00		10.00		\$ 260.00									
43		10/23/16		Operator 1		\$ 30.00		\$ 30.00		10.00		-		\$ 300.00		\$ -		\$ 300.00		Grader		8332		8332		\$ 67.50		10.00		\$ 675.00									
44		10/23/16		Operator 2		\$ 30.00		\$ 30.00		10.00		-		\$ 300.00		\$ -		\$ 300.00		4K Water Truck		8781		8781		\$ 50.00		10.00		\$ 500.00									
45		10/23/16		Operator 3		\$ 30.00		\$ 30.00		10.00		-		\$ 300.00		\$ -		\$ 300.00		Compactor Pneumatic Wheel		8223		8223		\$ 26.00		10.00		\$ 260.00									
46		10/23/16		Operator 1		\$ 30.00		\$ 30.00		10.00		-		\$ 300.00		\$ -		\$ 300.00		Grader		8332		8332		\$ 67.50		10.00		\$ 675.00									
47		10/23/16		Operator 2		\$ 30.00		\$ 30.00		10.00		-		\$ 300.00		\$ -		\$ 300.00		4K Water Truck		8781		8781		\$ 50.00		10.00		\$ 500.00									
48		10/23/16		Operator 3		\$ 30.00		\$ 30.00		10.00		-		\$ 300.00		\$ -		\$ 300.00		Compactor Pneumatic Wheel		8223		8223		\$ 26.00		10.00		\$ 260.00									
49		10/23/16		Operator 1		\$ 30.00		\$ 30.00		10.00		-		\$ 300.00		\$ -		\$ 300.00		Grader		8332		8332		\$ 67.50		10.00		\$ 675.00									
50		10/23/16		Operator 2		\$ 30.00		\$ 30.00		10.00		-		\$ 300.00		\$ -		\$ 300.00		4K Water Truck		8781		8781		\$ 50.00		10.00		\$ 500.00									
51		10/23/16		Operator 3		\$ 30.00		\$ 30.00		10.00		-		\$ 300.00		\$ -		\$ 300.00		Compactor Pneumatic Wheel		8223		8223		\$ 26.00		10.00		\$ 260.00									
52		10/23/16		Operator 1		\$ 30.00		\$ 30.00		10.00		-		\$ 300.00		\$ -		\$ 300.00		Grader		8332		8332		\$ 67.50		10.00		\$ 675.00									
53		10/23/16		Operator 2		\$ 30.00		\$ 30.00		10.00		-		\$ 300.00		\$ -		\$ 300.00		4K Water Truck		8781		8781		\$ 50.00		10.00		\$ 500.00									
54		10/23/16		Operator 3		\$ 30.00		\$ 30.00		10.00		-		\$ 300.00		\$ -		\$ 300.00		Compactor Pneumatic Wheel		8223		8223		\$ 26.00		10.00		\$ 260.00									
55		10/23/16		Operator 1		\$ 30.00		\$ 30.00		10.00		-		\$ 300.00		\$ -		\$ 300.00		Grader		8332		8332		\$ 67.50		10.00		\$ 675.00									
56		10/23/16		Operator 2		\$ 30.00		\$ 30.00		10.00		-		\$ 300.00		\$ -		\$ 300.00		4K Water Truck		8781		8781		\$ 50.00		10.00		\$ 500.00									
57		10/23/16		Operator 3		\$ 30.00		\$ 30.00		10.00		-		\$ 300.00		\$ -		\$ 300.00		Compactor Pneumatic Wheel		8223		8223		\$ 26.00		10.00		\$ 260.00									
58		10/23/16		Operator 1		\$ 30.00		\$ 30.00		10.00		-		\$ 300.00		\$ -		\$ 300.00		Grader		8332		8332		\$ 67.5													

	B	C	D	E	F	G	H	I	J	K	L	M	N	O	P	Q	R
84								\$	\$	\$						\$	
85								\$	\$	\$						\$	
86								\$	\$	\$						\$	
87								\$	\$	\$						\$	
88								\$	\$	\$						\$	
89	GRAND TOTALS										812.75	0.00	\$ 24,382.50	\$	812.50	\$ 42,417.14	

	B	C	D	E	F	G	H
1	PF-04	MATERIALS					
2	Invoice Date ("Used on" date for Stock Materials)	Materials with Description (include units and quantities)	Total Eligible Claimed Cost (Lump Sum)	Vendor	Invoice #	Orig. Invoice Amount IF Difference (reference only)	Notes/Comments
3	1/3/2011	(30) Tons of Gravel (Example)	\$ 750.00	STOCK	N/A		cost based on replacement value
4	1/7/2011	(64) Poles, 30', wood (Example)	\$ 900.00	Alpine Lumber Co	45783	\$2,603.21	invoice has ineligible items
5							
6		Select material: 455 tons @ \$2.50 per ton	\$ 1,137.50				
7							
8							
9		Chip Seal Material: 591 Sq Yds @ \$7.31/Yrd	\$ 4,320.21				
10		Chip Seal Material: 560 Sq Yds @ \$7.31/Yrd	\$ 4,093.60				
11		Chip Seal Material: 202 Sq Yds @ \$7.31/Yrd	\$ 1,476.62				
12		Select material: 37 tons @ \$2.50 per ton	\$ 92.50				
13		Chip Seal Material: 467 Sq Yds @ \$7.31/Yrd	\$ 3,413.77				
14		Select material: 78 tons @ \$2.50 per ton	\$ 195.00				
15		Chip Seal Material: 934 Sq Yds @ \$7.31/Yrd	\$ 6,827.54				
16		Select material: 125 tons @ \$2.50 per ton	\$ 312.50				
17		Chip Seal Material: 622 Sq Yds @ \$7.31/Yrd	\$ 4,546.82				
18		Chip Seal Material: 489 Sq Yds @ \$7.31/Yrd	\$ 3,574.59				
19		Select material: 132 tons @ \$2.50 per ton	\$ 330.00				
20		Chip Seal Material: 489 Sq Yds @ \$7.31/Yrd	\$ 3,574.59				
21		Select material: 140 tons @ \$2.50 per ton	\$ 350.00				
22		Chip Seal Material: 112 Sq Yds @ \$7.31/Yrd	\$ 818.72				
23		Chip Seal Material: 451 Sq Yds @ \$7.31/Yrd	\$ 3,296.81				
24							
25		Select material: 1,719 tons @ \$2.50 per ton	\$ 4,297.50				
26							
27							
28							
29							
30							
31							
32							
33		GRAND TOTAL	\$ 42,658.27				

ARIZONA DIVISION OF EMERGENCY MANAGEMENT

NARRATIVE

DECLARATION NO.				PW REF NO.	DATE	FIPS NO.	CATEGORY	NEMIS NO.
ADEM	73051	DR	AZ	PF-04	11/22/19		C	
APPLICANT							COUNTY	
Pinal County							Pinal County	

NARRATIVE

Road and/or shoulder damage sites on Stanfield Rd, Papago Rd and Hidden Valley Rd (rock slide), were not included in this Project Worksheet since Pinal County will pursue reimbursement under the FHWA ER Program.

PREPARED BY: Alex Barber

TITLE: ADEM Project Specialist

LOCATION MAP

APPLICANT:	Pinal County	DATE:	11/22/19
FIPS NO.		PW REF NO.	PF-04

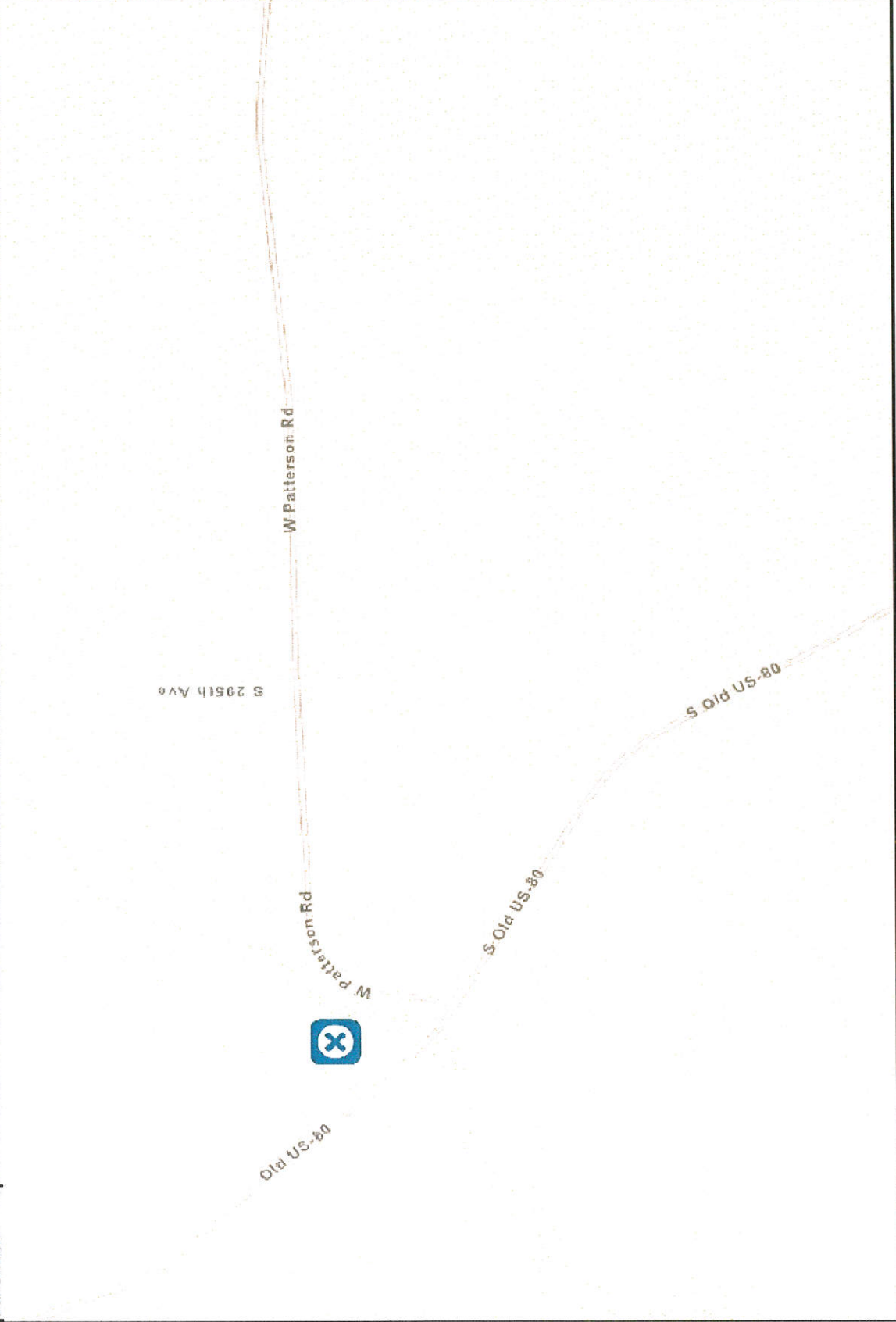

FIRMETTE

APPLICANT:	Pinal County	DATE:	11/22/19
FIPS NO.		PW REF NO.	PF-04

National Flood Hazard Layer FIRMette



Legend

SEE REPORT FOR DETAILED LEGEND AND INDEX MAP FOR FULL PANEL LAYOUT

SPECIAL FLOOD HAZARD AREAS

- Without Base Flood Elevation (BFE)
- With BFE or Depth Zone AE, AH, AR, AP
- Regulatory Floodway

OTHER AREAS OF FLOOD HAZARD

- 0.2% Annual Chance Flood Hazard: Areas of 1% annual chance flood with average depth less than one foot or with drainage areas of less than one square mile.
- Future Conditions 1% Annual Chance Flood Hazard
- Area with Reduced Flood Risk due to Levees: See Notes.
- Area with Flood Risk due to Levees

OTHER AREAS

- Area of Minimal Flood Hazard
- Effective LOMR
- Area of Undetermined Flood Hazard
- Channel, Culvert, or Storm Sewer
- Levee, Dike, or Floodwall

OTHER FEATURES

- Cross Sections with 1% Annual Chance Water Surface Elevation
- Coastal Transect
- Base Flood Elevation Line (BFE)
- Limit of Study
- Jurisdiction Boundary
- Coastal Transect Baseline
- Profile Baseline
- Hydrographic Feature

MAP PANELS

- Digital Data Available
- No Digital Data Available
- Unmapped

The pin displayed on the map is an approximate point selected by the user and does not represent an authoritative property location.

This map complies with FEMA's standards for the use of digital flood maps. It is not void as described below. The base map shown complies with FEMA's base map accuracy standards.

The flood hazard information is derived directly from the authoritative NFHL web services provided by FEMA. This map was exported on 12/10/2018 at 10:41:02 AM and does not reflect changes or amendments subsequent to this date and time. The NFHL and effective information may change or become superseded by new data over time.

This map image is void if the one or more of the following map information is not present: map creation date, community identifier, panel number, and map effective date. Map images for unmapped and unmapped areas cannot be used for regulatory purposes.

PHOTO SHEET

APPLICANT:	Pinal County	DATE:	11/22/19
FIPS NO.		PW REF NO.	PF-04

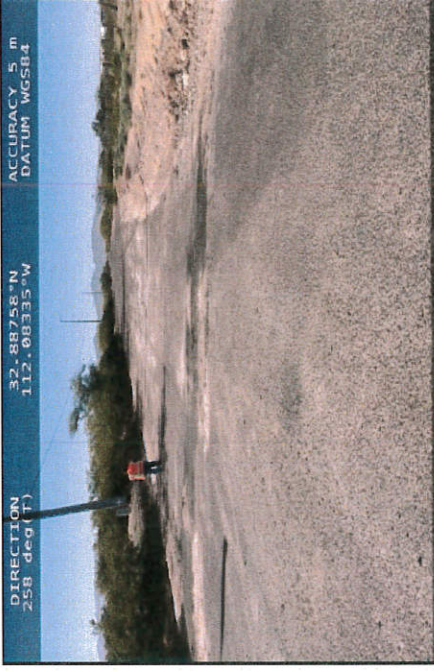

Site 1: Huisatch Rd & Amarillo Valley Rd Intersection.
Chip Seal damage. DEMMA Photo.

DIRECTION 258 deg (T) 32.88758°N
112.08335°W ACCURACY 5 m
DATUM WGS84

2018-11-28
13:08:57-07:00

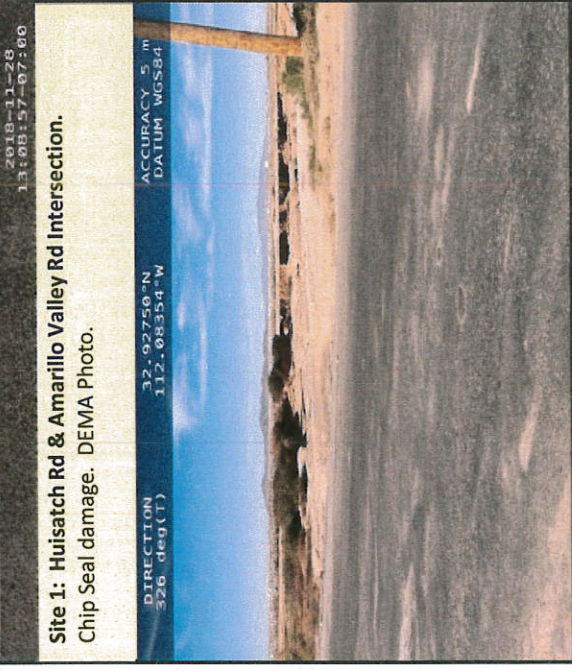

Site 3: Barnes Rd & Amarillo Valley Rd Intersection.
Shoulder and Chip Seal damage. DEMMA Photo.

DIRECTION 326 deg (T) 32.92750°N
112.08354°W ACCURACY 5 m
DATUM WGS84

2018-11-27
13:50:33-07:00

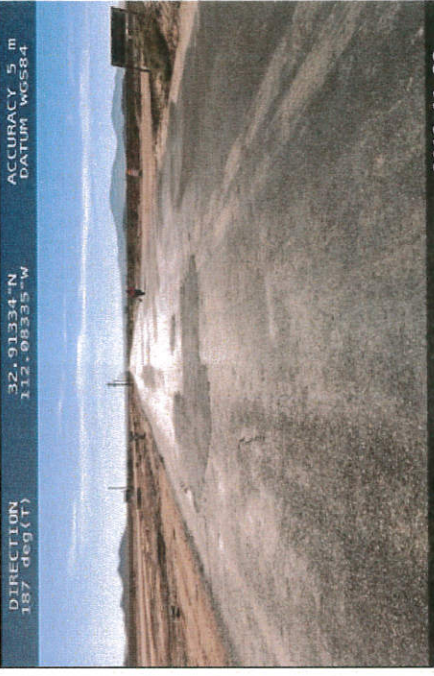

Site 2: Amarillo Valley Rd & Meadow Green Rd Intersection
Chip Seal damage. DEMMA Photo.

DIRECTION 187 deg (T) 32.91334°N
112.08335°W ACCURACY 5 m
DATUM WGS84

2018-11-28
11:31:01-07:00

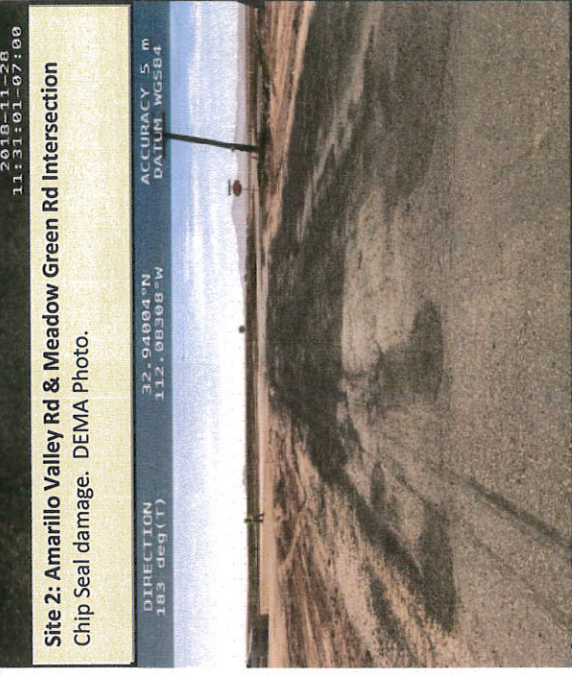

Site 4: Amarillo Valley Rd (between Louis Johnson Rd and Teel Rd)

DIRECTION 185 deg (T) 32.94004°N
112.08308°W ACCURACY 5 m
DATUM WGS84

2018-11-28
11:20:20-07:00

PHOTO SHEET

APPLICANT:	Pinal County	DATE:	11/22/19
FIPS NO.		PW REF NO.	PF-04

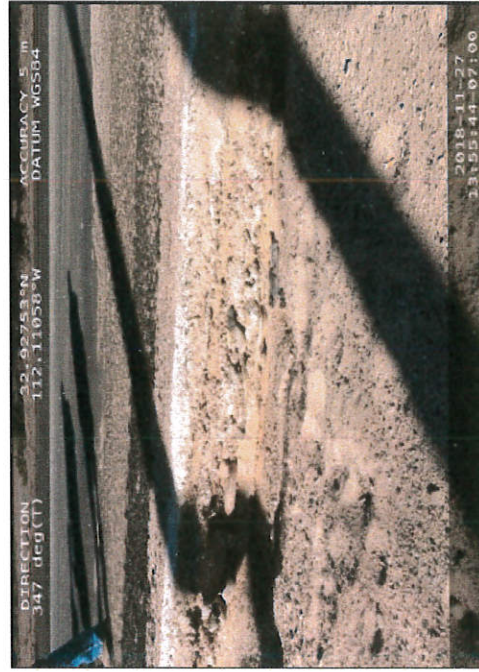

Site 5: Barnes Rd and Appalosa Dip Intersection.
Should and Chip Seal damage. DEMO Photo.



Site 7: Wildwood Rd (between Garnett Rd & Pick Rd)
Damaged Chip Seal. DEMO Photo.

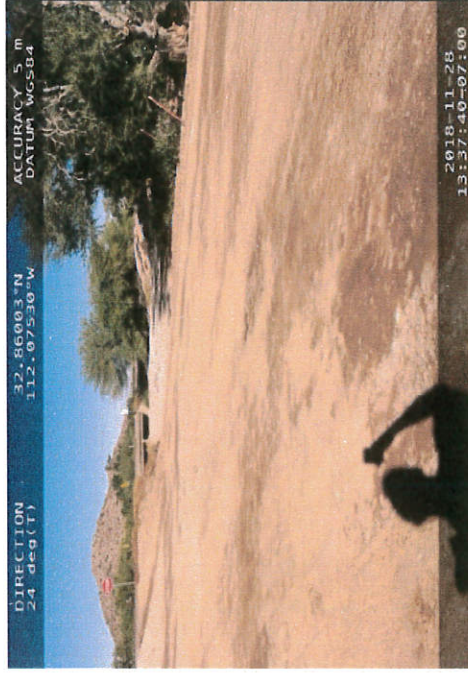

Site 6: Liebre Rd & State Route 84 Intersection.
Repair of damaged roadway completed. DEMO Photo.

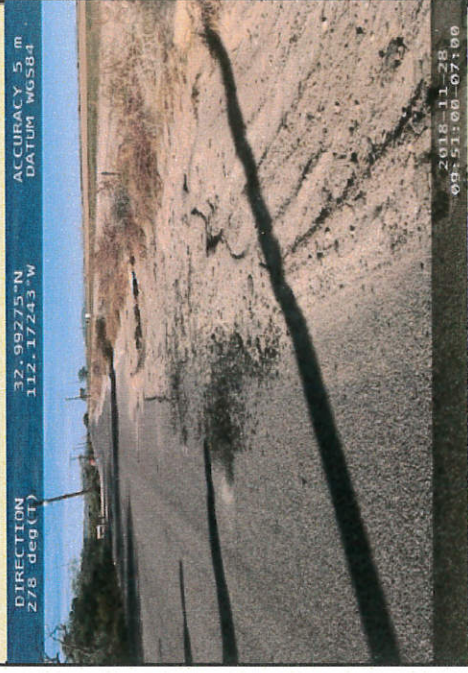

Site 8: Fulcar Rd
Damaged south side shoulder and chip seal. DEMO Photo.

PHOTO SHEET

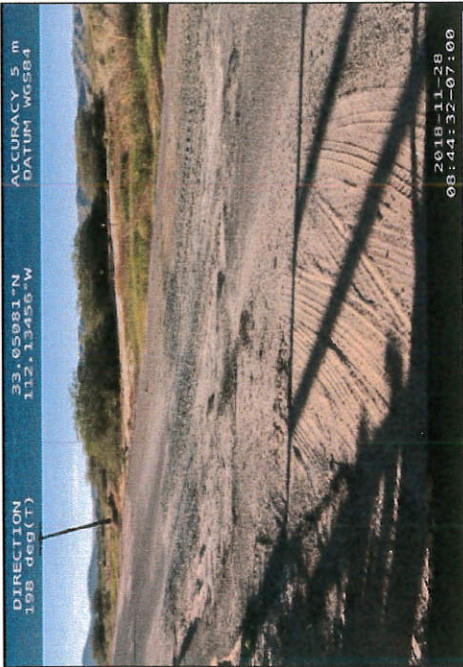
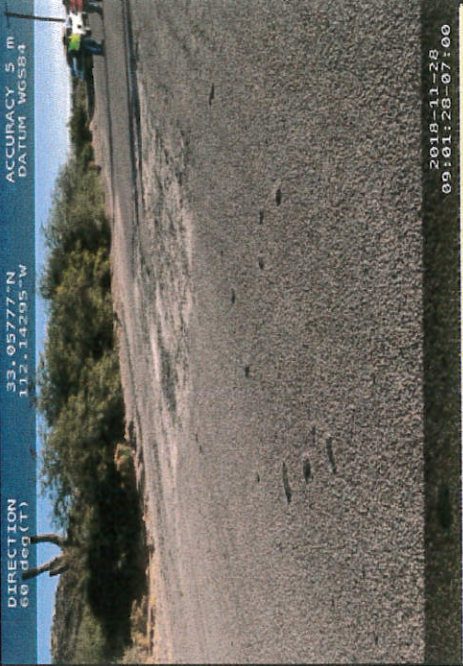
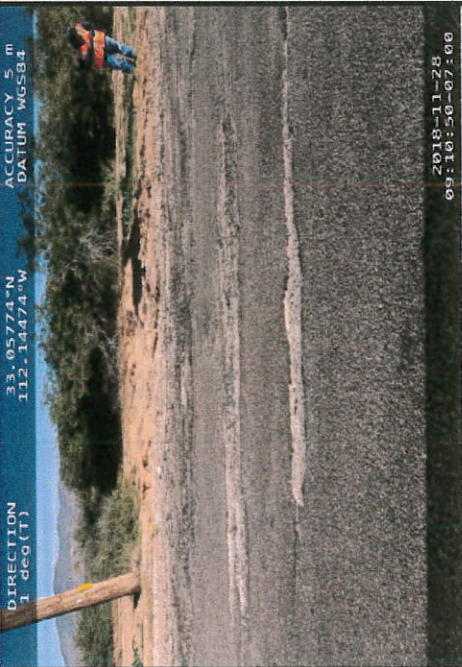
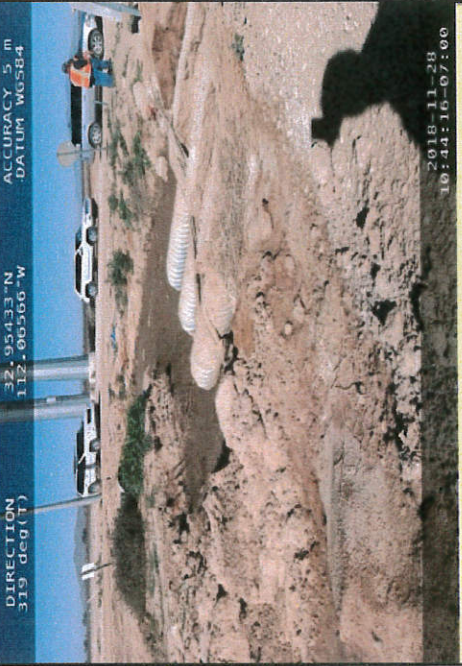
APPLICANT:	Pinal County	DATE:	11/22/19
FIPS NO.		PW REF NO.	PF-04
 <p>DIRECTION 108 deg(T) 33.05081°N 112.13456°W ACCURACY 5 m DATUM WGS84</p> <p>2018-11-28 08:44:32-07:00</p> <p>Site 9: Warren Rd (between Farrell Rd & McDavid Rd) Damaged shoulder and chip seal. DEMO Photo.</p>			
 <p>DIRECTION 60 deg(T) 33.05777°N 112.34295°W ACCURACY 5 m DATUM WGS84</p> <p>2018-11-28 09:01:28-07:00</p> <p>Site 10: McDavid Rd (West of Warren Rd) Damaged chip seal. DEMO Photo.</p>			
 <p>DIRECTION 31 deg(T) 33.05774°N 112.14474°W ACCURACY 5 m DATUM WGS84</p> <p>2018-11-28 09:10:50-07:00</p> <p>Site 11: McDavid Rd Damaged chip seal. DEMO Photo.</p>			
 <p>DIRECTION 319 deg(T) 33.05433°N 112.00560°W ACCURACY 5 m DATUM WGS84</p> <p>2018-11-28 10:44:10-07:00</p> <p>Site 12: Teel Rd & Green Rd Intersection. Damaged shoulder and unpaved road surface. DEMO Photo.</p>			

HAZARD MITIGATION PROPOSAL (HMP) SUMMARY

DISASTER		APPLICANT	PW REF NO.	FIPS NO.	CATEGORY
AZ	73051	Pinal County	PF-04		C

☐ Mitigation activity will be performed on sites in this project.

☒ If there is no mitigation activity explain why not.

Applicant has not requested mitigation

☐ 404 Mitigation (Category A projects only)

☐ Codes and Standards

☐ Good Construction Practices

☐ Mitigation Policy

☐ 15 percent

☐ 100 percent list

☐ Benefit/Cost Ratio (Attach B/C analysis)

☐ Other:

Enter cost of mitigation project as percent of in-kind repair or as dollar amount:

Dollar Amount:

Percent:

☐ Check here if you wish to attach a Hazard-Mitigation Proposal

Prepared By: Alex Barber

11/22/2019

REPETITIVE LOSS STATEMENT

APPLICANT	PW REF NO.	FIPS NO.	CATEGORY	DISASTER	
Pinal County	PF-04		C	AZ	73051

1. **Has this project / site had previous damage?**
(If the answer is NO, It is not necessary to address the remaining questions) ☐ Yes ☐ No ☒ Unsure

2. **Did FEMA provide funding for the repair of this previous damage?**
(If the answer is NO, It is not necessary to address the remaining questions) ☐ Yes ☐ No ☒ Unsure

3. **What is the date and cause of the previous damage?**

Date (MM/DD/YY):

- ☐ Fire
☐ Flood
☐ Earthquake
☐ Tornado / Wind
☐ Hail / Rain

4. **Was mitigation approved in the previous disaster?** ☐ Yes ☐ No ☐ Unsure

5. **Was the mitigation work completed prior to this disaster?** ☐ Yes ☐ No ☐ Unsure

6. **If known, provide the following information on the previous disaster:**

Disaster No:

PW No:

Version No:

7. **Comments:**