

When recorded mail to:
Clerk of the Board
P.O. Box 827
Florence, AZ 85132

CONSENT AGREEMENT FOR TRANSFER OF COUNTY RIGHT-OF-WAY

THIS CONSENT AGREEMENT FOR TRANSFER OF COUNTY RIGHT-OF-WAY (Agreement") is made this ___ day of _____, 2023, by and between **PINAL COUNTY**, a political subdivision of the State of Arizona ("the County") and the **CITY OF COOLIDGE**, an Arizona municipal corporation ("the City"). The County and the City are sometimes hereinafter referred to as the ("Parties").

RECITALS

WHEREAS, the County is the owner of a certain right-of-way legally described and depicted on the attached **Exhibit A** (the "Right-of-Way"); and

WHEREAS, the Parties desire that the Right-of-Way be transferred from the County to the City; and

WHEREAS, the parties are authorized to enter into this Agreement pursuant to Arizona Revised Statutes § 9-471 (O).

AGREEMENT

NOW THEEFORE, in consideration of these premises and of the mutual covenants and agreements hereinafter contained, the Parties hereto agree and grant their consent as follows:

1. **TRANSFER:** Any and all right, title and interest, if any, the County has in the Right-of-Way is hereby transferred to the City.
2. **RIGHT-OF-WAY OBLIGATIONS:** The County shall have no further obligations in connection with the Right-of-Way, which obligations shall be the sole responsibility of the City.
3. **CONFLICT OF INTEREST:** The Parties acknowledge that this Agreement is subject to cancellation pursuant to A.R.S. § 38-511.

IN WITNESS WHEREOF, the Parties hereto, have executed this Agreement as of the day and year set forth below.

PINAL COUNTY, a political subdivision of the State of Arizona

By: _____
Chairman of the Board

ATTEST:

Clerk of the Board

APPROVED AS TO FORM:

Deputy County Attorney

CITY OF COOLIDGE, an Arizona municipal corporation

By: _____
City Mayor

ATTEST:

City Clerk

APPROVED AS TO FORM:

City Attorney

EXHIBIT A
TO
TRANSFER OF COUNTY RIGHT-OF-WAY

[Legal Descriptions of Right-of- Way]

See following pages.

DESCRIPTION

THAT PORTION OF SECTION 36, TOWNSHIP 6 SOUTH, RANGE 7 EAST OF THE GILA AND SALT RIVER MERIDIAN, PINAL COUNTY, ARIZONA DESCRIBED IN DOCKET 37, PAGE 581, FILED AND RECORDED IN THE OFFICE OF THE COUNTY RECORDER OF PINAL COUNTY, ARIZONA ON JANUARY 16, 1951 AS THE SOUTH 40 FEET OF THE SOUTHWEST QUARTER OF SAID SECTION 36 LESS THE WEST HALF OF THE SOUTHWEST QUARTER OF THE SOUTHWEST QUARTER OF THE SOUTHWEST QUARTER OF SAID SECTION 36.

TOGETHER WITH:

THE SOUTH 40 FEET OF THE WEST HALF OF THE SOUTHWEST QUARTER OF THE SOUTHWEST QUARTER OF THE SOUTHWEST QUARTER OF SECTION 36, TOWNSHIP 6 SOUTH, RANGE 7 EAST OF THE GILA AND SALT RIVER MERIDIAN, PINAL COUNTY, ARIZONA DESCRIBED IN DOCKET 38, PAGE 19, FILED AND RECORDED IN THE OFFICE OF THE COUNTY RECORDER OF PINAL COUNTY, ARIZONA ON JANUARY 17, 1951.



3/31/2024

Selma Hwy ROW Transfer

In Section 36 Township 6S Range 7E

■ ROW To Be Transferred

□ Section

■ City of Coolidge

□ City of Eloy



35

36

Selma Hwy

Mary K Dr

Valerian St

2

1

Tweedy Rd

Grogan Ave

DESCRIPTION

THOSE PORTIONS OF SECTION 1, TOWNSHIP 7 SOUTH, RANGE 7 EAST OF THE GILA AND SALT RIVER MERIDIAN, PINAL COUNTY, ARIZONA DESCRIBED IN DOCKET 37, PAGE 581, FILED AND RECORDED IN THE OFFICE OF THE COUNTY RECORDER OF PINAL COUNTY, ARIZONA ON JANUARY 16, 1951 AS THE NORTH 40 FEET OF THE NORTHWEST QUARTER AND THE NORTH 40 FEET OF THE WEST HALF OF THE WEST HALF OF THE NORTHEAST QUARTER OF SAID SECTION 1.



Selma Hwy ROW Transfer

In Section 1 Township 7S Range 7E

■ ROW To Be Transferred

□ Section

■ City of Coolidge

□ City of Eloy



35

36

Selma Hwy

Mary K Dr

Valerian St

2

1

Tweedy Rd

Grogan Ave

DESCRIPTION

THE SOUTH 50 OF THE EAST HALF OF THE EAST HALF OF THE WEST HALF OF THE EAST HALF OF THE SOUTHWEST QUARTER AND THE EAST HALF OF THE EAST HALF OF THE SOUTHWEST QUARTER OF SECTION 32, TOWNSHIP 6 SOUTH, RANGE 8 EAST OF THE GILA AND SALT RIVER MERIDIAN, PINAL COUNTY, ARIZONA.



Selma Hwy ROW Transfer

In Section 32 Township 6S Range 8E

■ ROW To Be Transferred

□ Section

■ City of Coolidge



31

32

33

Sunshine Blvd

6

5

4

Selma Hwy

La Palma Rd

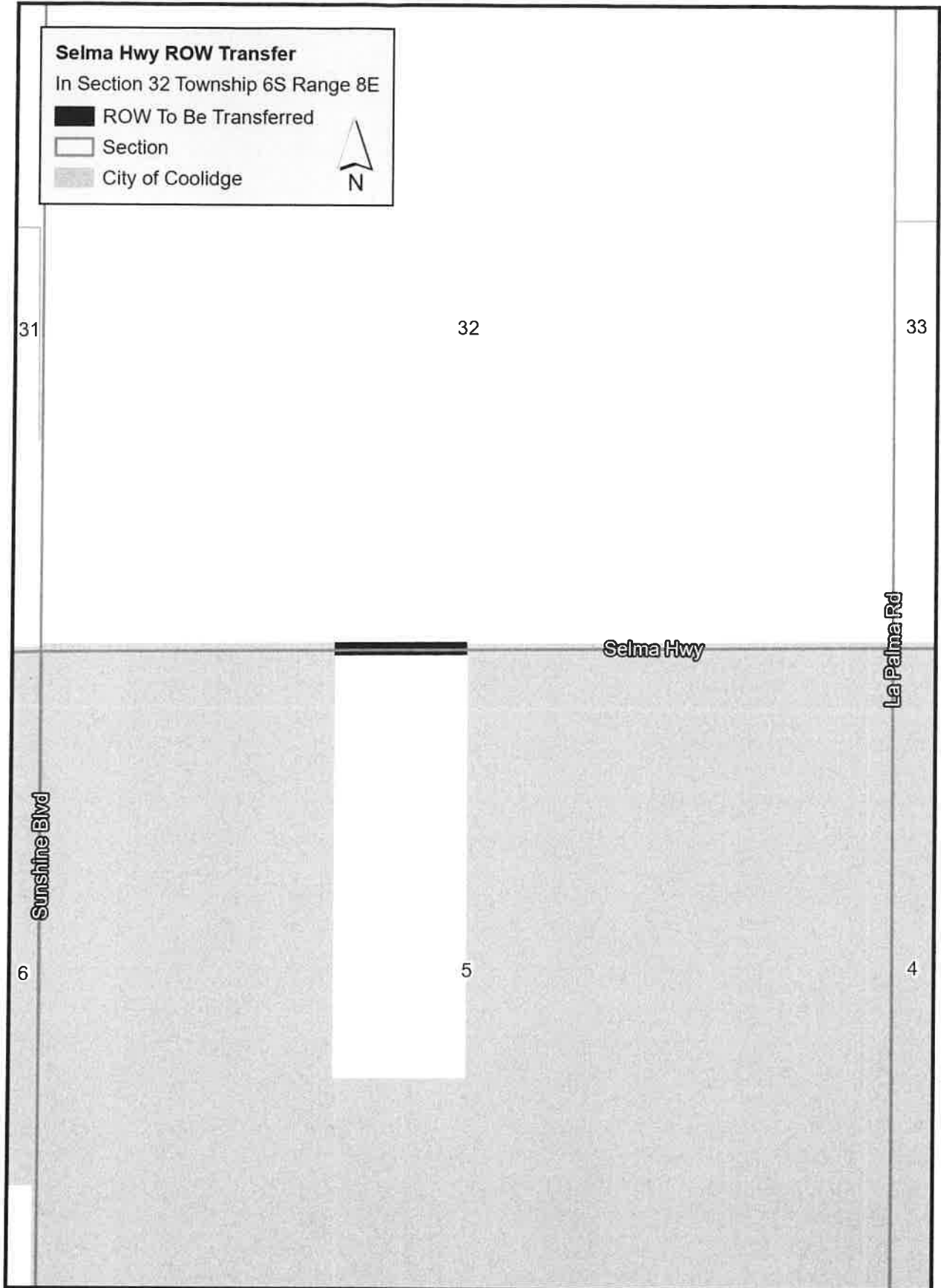

DESCRIPTION

THE NORTH 33 OF THE EAST HALF OF THE EAST HALF OF THE WEST HALF OF THE EAST HALF OF THE NORTHWEST QUARTER AND THE EAST HALF OF THE EAST HALF OF THE NORTHWEST QUARTER OF SECTION 5, TOWNSHIP 7 SOUTH, RANGE 8 EAST OF THE GILA AND SALT RIVER MERIDIAN, PINAL COUNTY, ARIZONA.



EXD. 3/31/2024

Selma Hwy ROW Transfer

In Section 5 Township 7S Range 8E

■ ROW To Be Transferred

□ Section

■ City of Coolidge



31

32

33

Sunshine Blvd

6

5

4

Selma Hwy

La Palma Rd

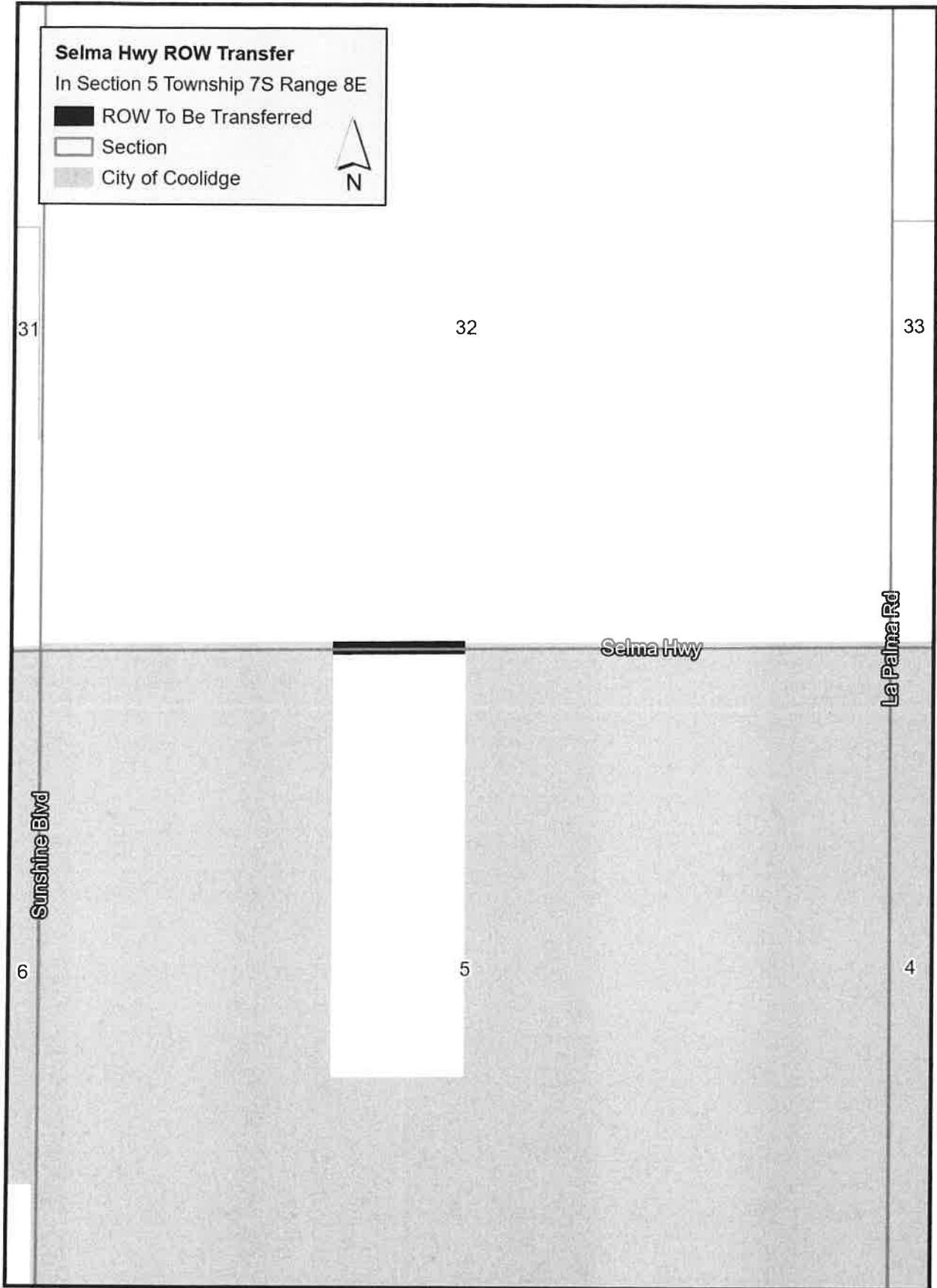

DESCRIPTION

THAT PORTION OF SECTION 15, TOWNSHIP 6 SOUTH, RANGE 8 EAST OF THE GILA AND SALT RIVER MERIDIAN, PINAL COUNTY, ARIZONA AS SHOWN ON AMENDED RECORD OF SURVEY MINOR LAND DIVISION RECORDED IN BOOK 7, PAGE 055 OF SURVEYS RECORDED IN THE OFFICE OF THE COUNTY RECORDER OF PINAL COUNTY, ARIZONA ON OCTOBER 15, 2002 AS THE SOUTH 33 FEET OF THE EAST 1179.58 FEET OF THE SOUTHWEST QUARTER OF SAID SECTION 15;

TOGETHER WITH:

THE SOUTH 33 FEET OF THE WEST 125 FEET OF THE EAST 1304.58 FEET OF THE SOUTHWEST QUARTER OF SAID SECTION 15, AS DESCRIBED AS A RAILROAD RIGHT OF WAY IN BOOK 39 OF DEEDS, PAGE 586 AND BOOK 41 OF DEEDS, PAGE 584 RECORDED IN THE OFFICE OF THE COUNTY RECORDER OF PINAL COUNTY, ARIZONA.



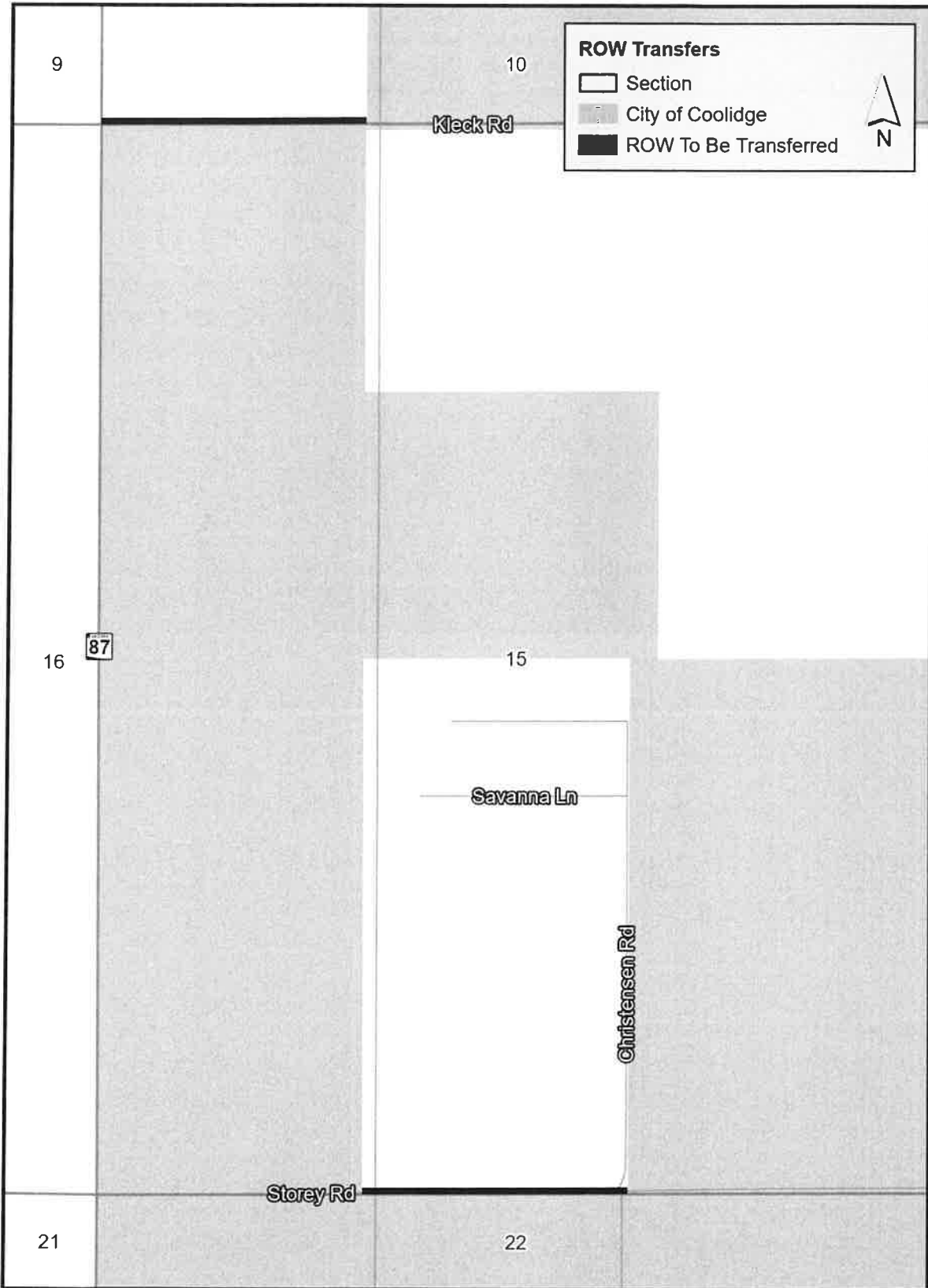



Storey Rd ROW Transfer

In Section 10 Township 6S Range 8E

 Section

 City of Coolidge

 ROW To Be Transferred



15

Christensen Rd

Storey Rd

22